

eumardesign

Portal 01



portal

Installation Instruction

Portal O1 installation manual

This document is an installation and connection manual for the Portal product manufactured by Eumar. Follow the guidelines in this document to install the product correctly.

NB! Please note that some steps for installing and connecting the product can only be performed by authorized and specially trained qualified personnel!

Portal O1 washbasin set include:

1. Portal O1 mirror frame – 1pc
2. Portal washbasin 54c – 1pc
3. Portal washbasin 54c service hatch – 1pc
4. Faucet – 1pc
5. Bottle space-saving trap – 1pc
6. Portal O1 set wall fixing set (bolt +nut) - 3pcs
7. Portal washbasin 54c fixing set (bolt +nut) – 4pcs

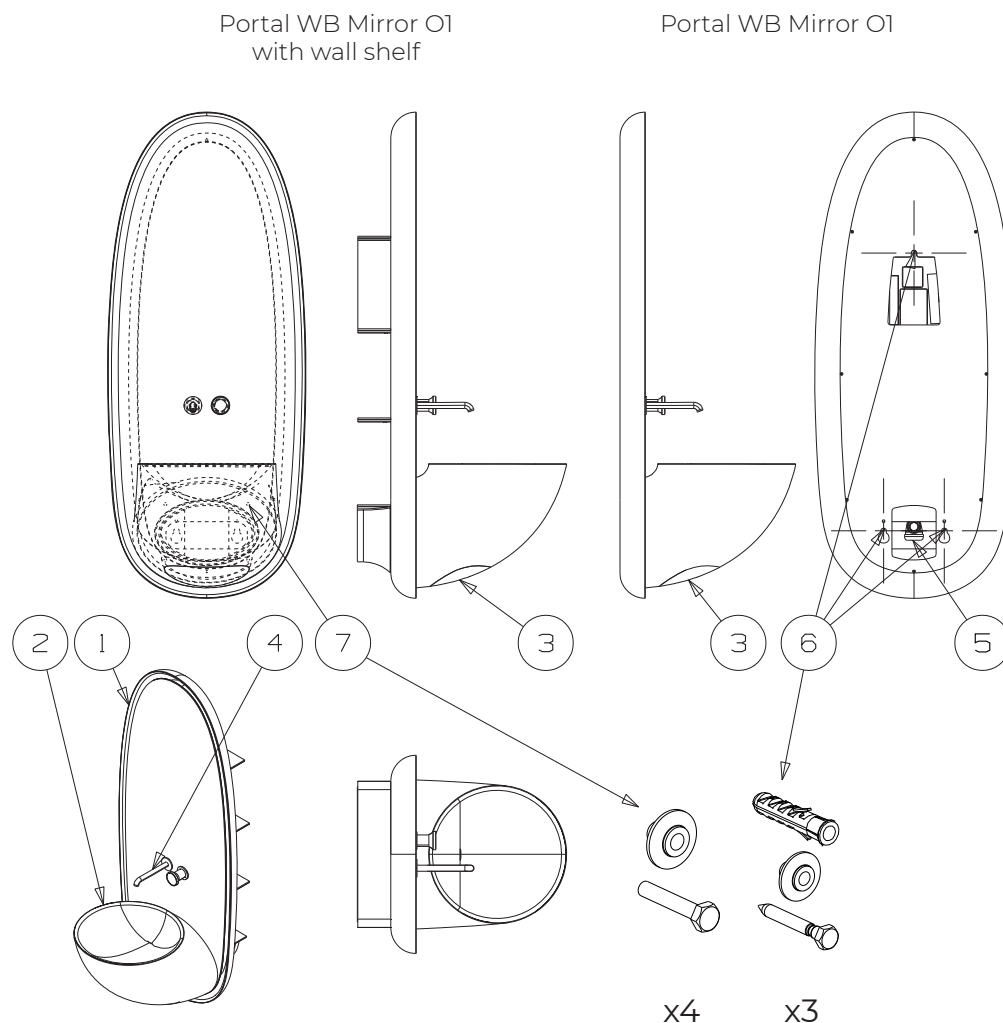

Installation instructions (Part 1)

1. Mark the mounting points of the product on the wall according to the drawings. Drill the required number of holes, insert the necessary dowels (Fig.2)
2. Tighten the 3 screws with the spacer washers (Fig. 3 and Fig.4)
3. Move the product closer to the wall by 20-25 cm, connect the electrical part of the device (connecting the device to a power supply cable. Hang the product on the bracket. Make sure that the power cable and water heaters are not pinched anywhere (Fig.5).
4. Connect the water supply hoses.

Attention! This connection should only be performed by specially trained and qualified personnel.

5. Turn on the water supply and check the pipe connections for leakages. After checking, turn off the water supply (Fig.6).

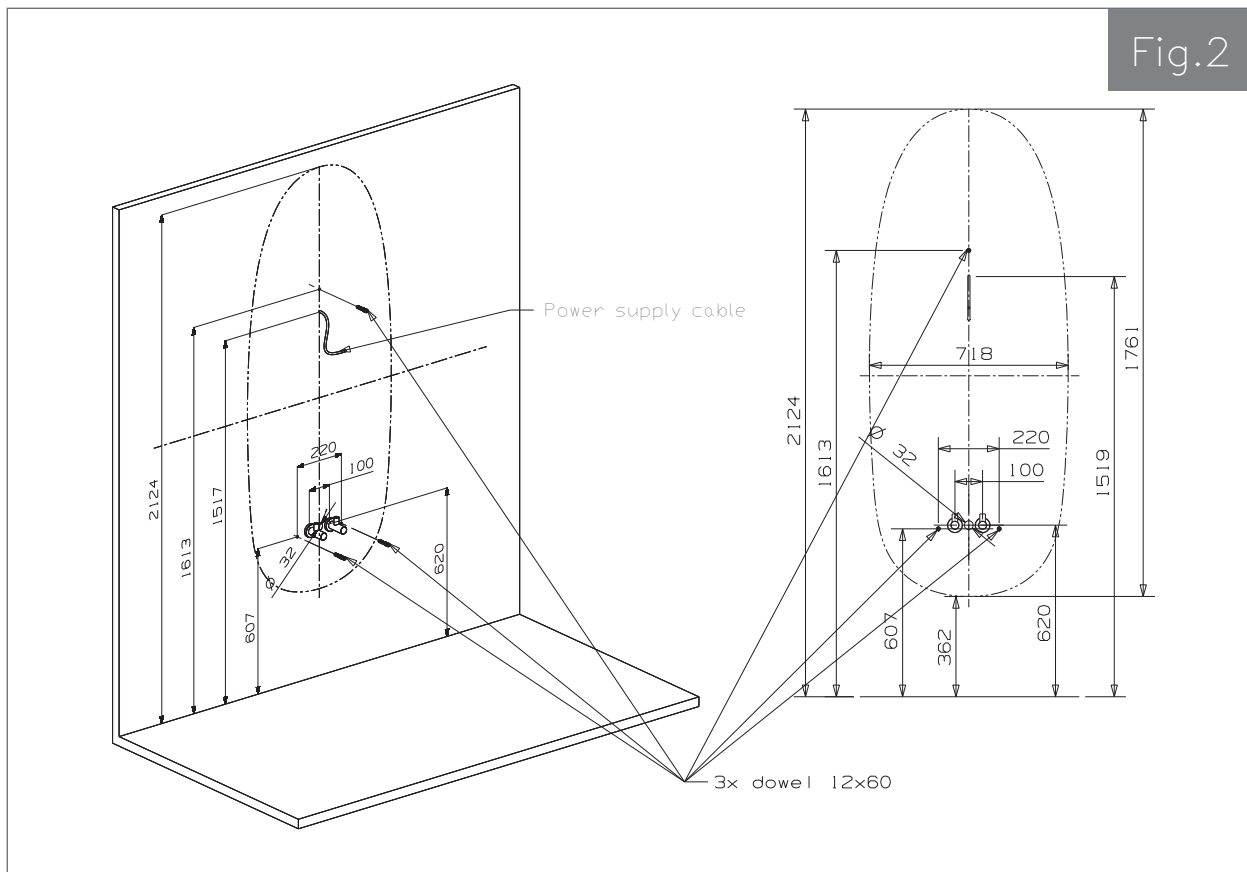

Fig.2

Fig.3

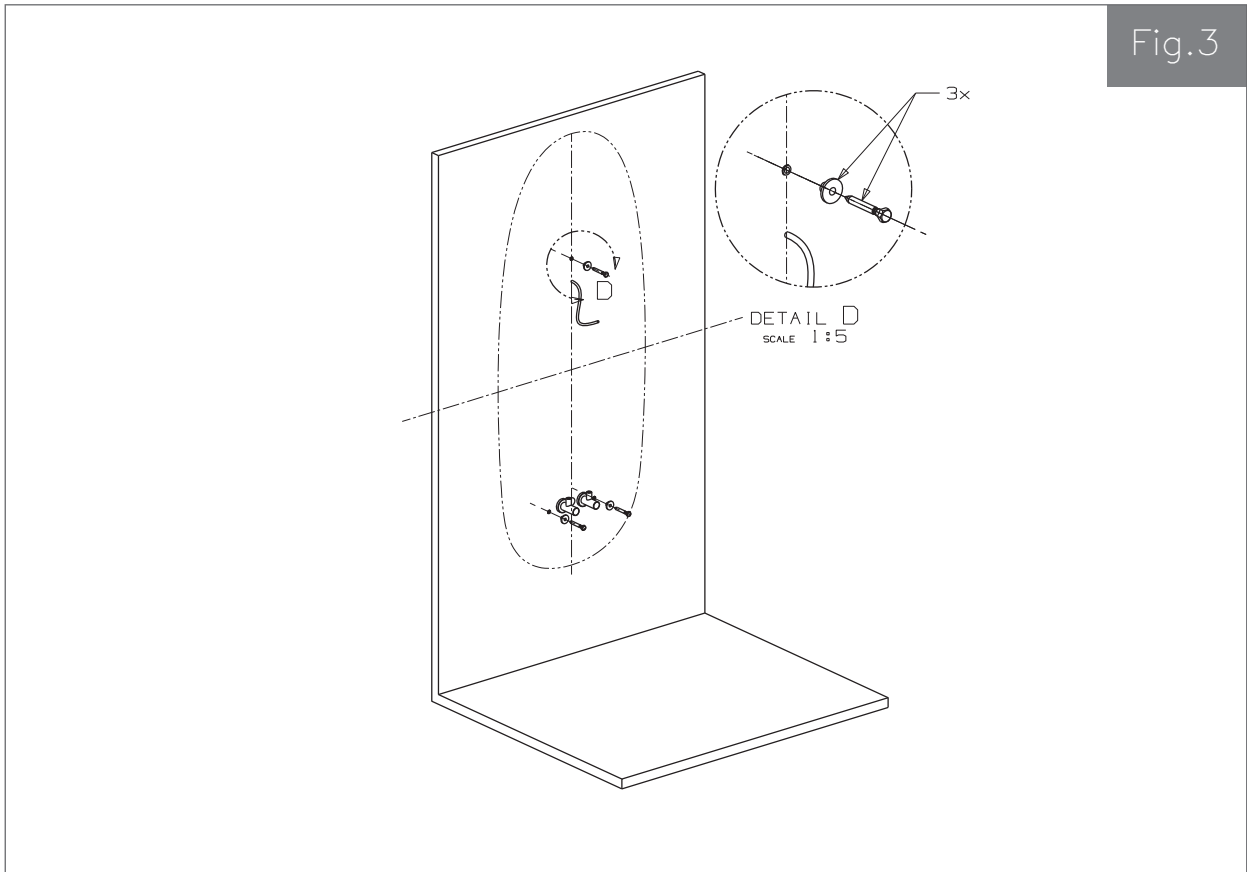

Fig.4

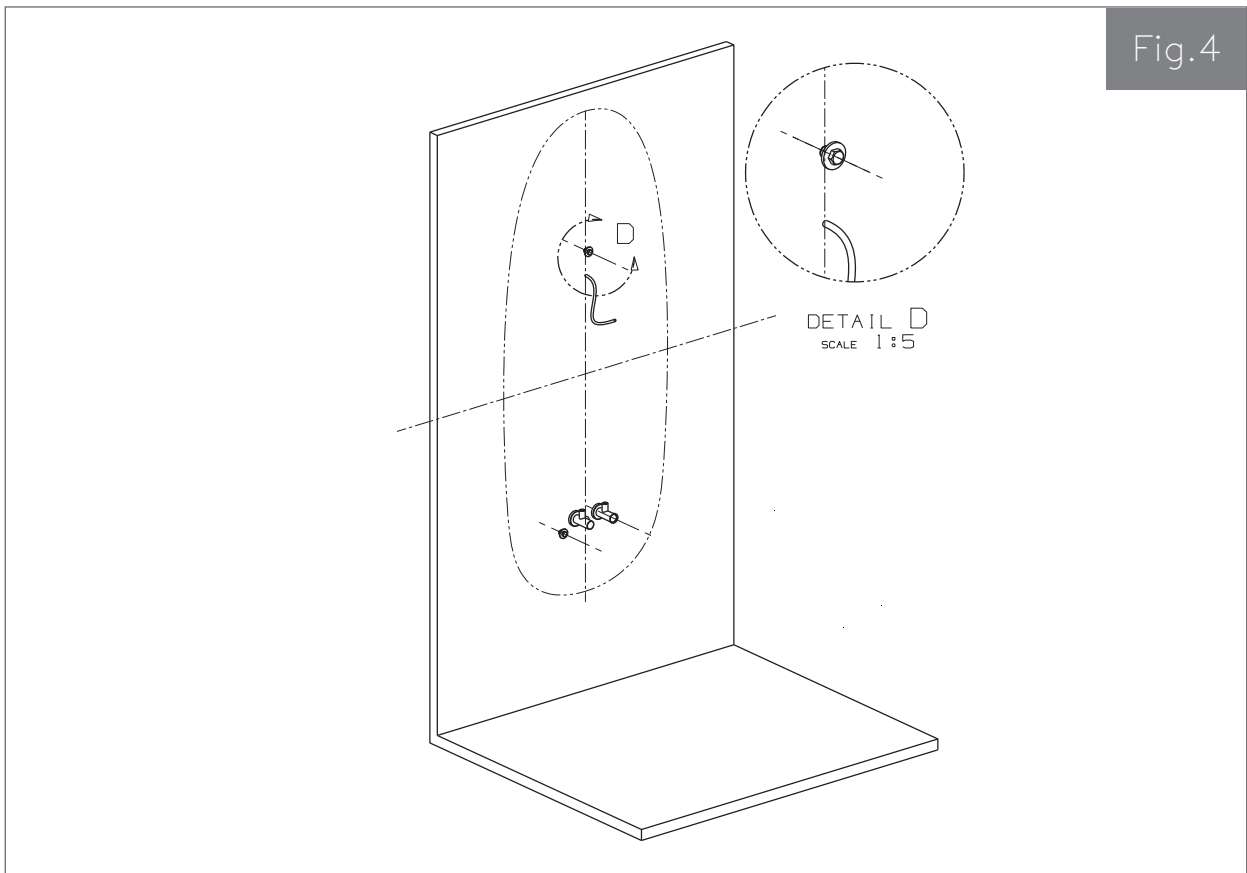

Fig.5

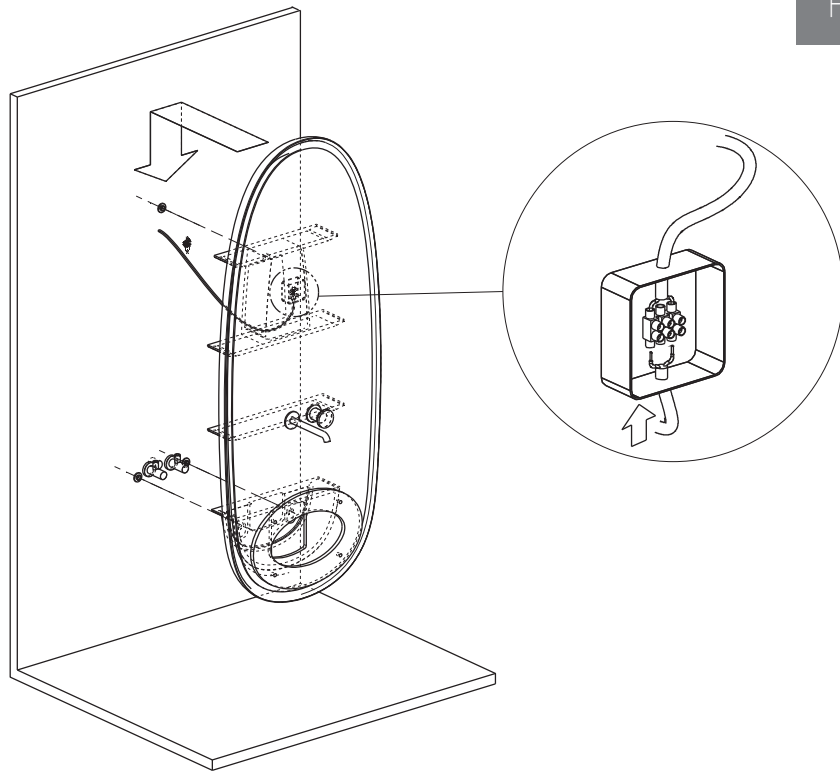
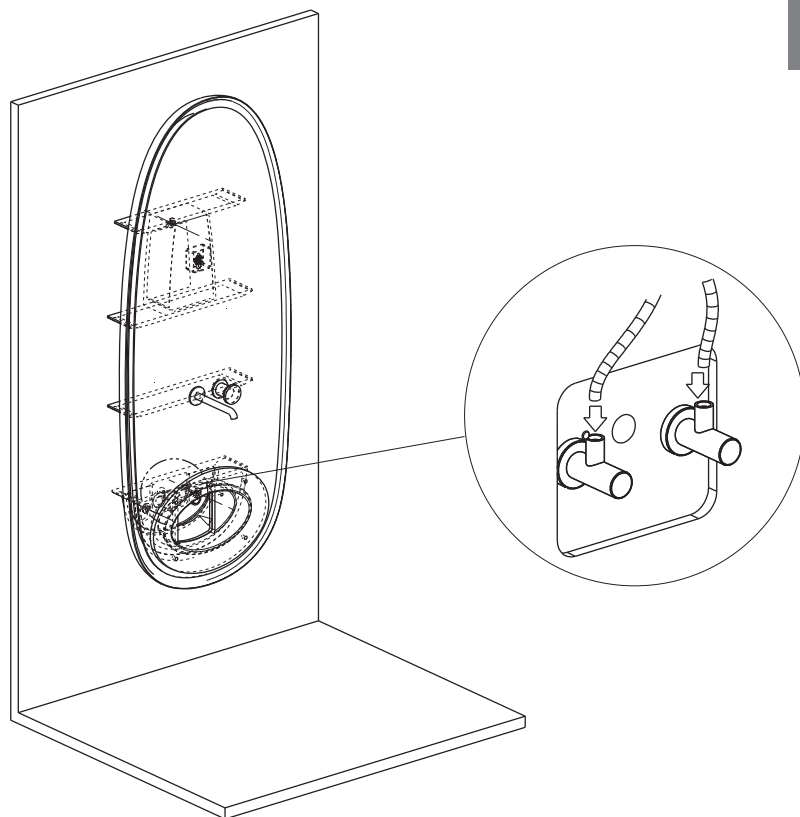

Fig.6



Connecting the product to the power supply.



After connecting the water and sewer pipes, you can connect the electrical part to the power source. **Attention!** This procedure is allowed only by authorized personnel!

Warning / Caution!

- a. Connecting the wires of the power cable is made strictly in accordance with the requirements and standards of your state.
- b. Risk of electrical shock and energy hazard. All failure should be examined by a qualified technician. Please do not remove the case of the power supply by yourself!
- c. Please do not install LED power supplies in places with high ambient temperature or close to fire source.
- d. The power cable must not be connected to the main voltage supply! Ensure that it cannot be re-connected inadvertently!

Drivers in product Portal are Class II power unit, have fully isolated plastic case, do not need Ground/Earth wire. Power supply cable can have only 2 wires. If you are using a power cable with a Ground/Earth wire, then connect it in the terminal block on the product. None of the cable wires should be left unlocked in the terminal block!

Typical wires connections are:

AC/L(Brown) from the drivers must be connected to AC/L (Brown or Black) of power supply cable.

AC/N(Blue) from the drivers must be connected to AC/N (Blue or White) of power supply cable.

Check again for correct connections.

Turn on the power to the product.

Check the electrical function of the product.

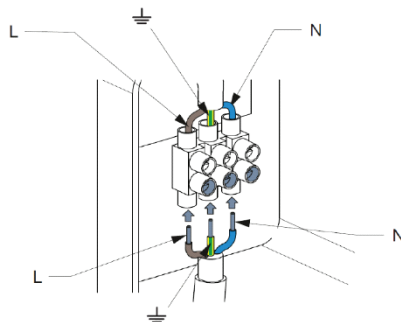

Installation instructions (Part 2)

1. Disconnect the device from the power supply.
2. Install the washbasin, fix it to the flange with screws with washers (Fig.7)
4. Install the water trap/ siphon for the washbasin.
5. Connect the washbasin siphon drain pipe to the wall drain pipe. (Fig. 8).
6. Turn on the water supply by opening the water supply valves.
7. Open on the faucet water supply and check the connections of the drain pipes.
8. Install the service hatch at the bottom of the washbasin.
9. Turn on the power supply.

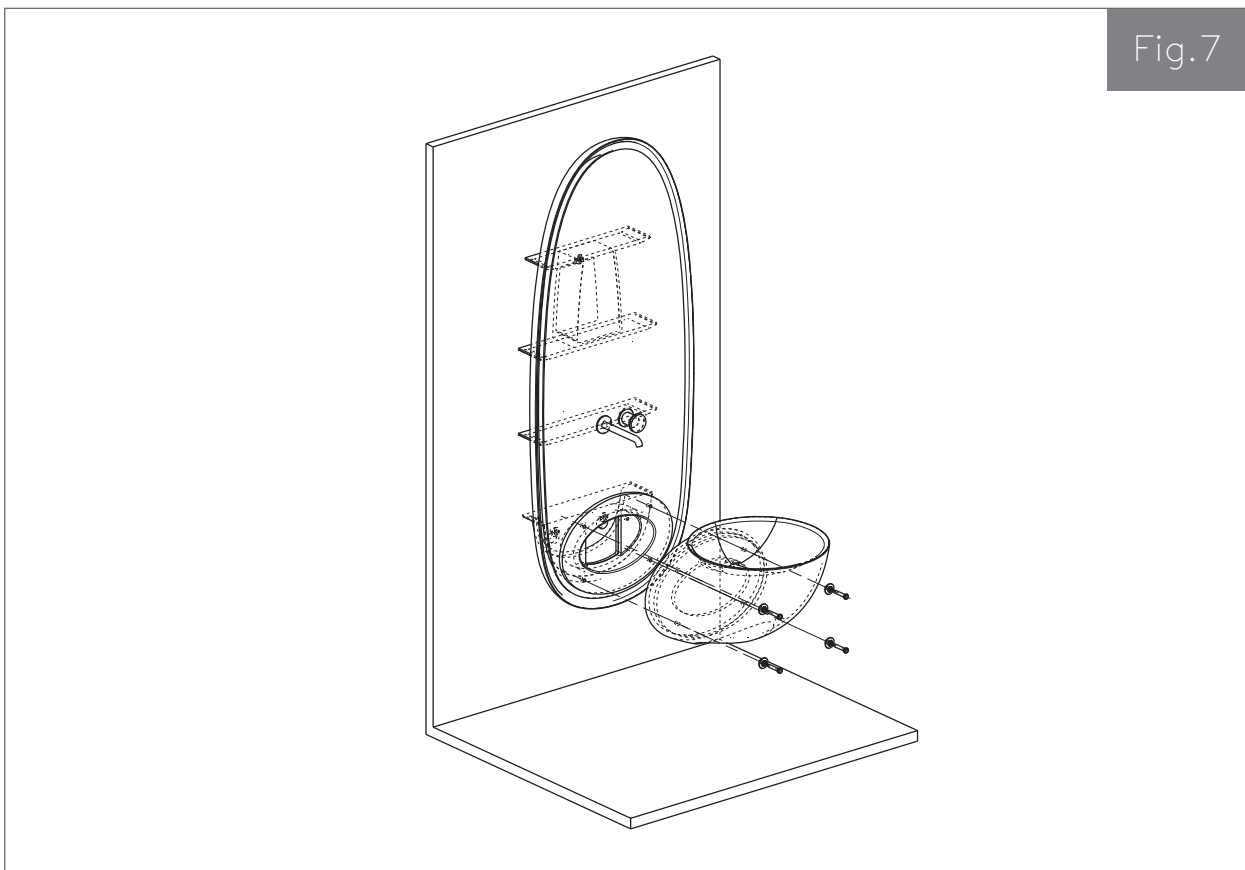
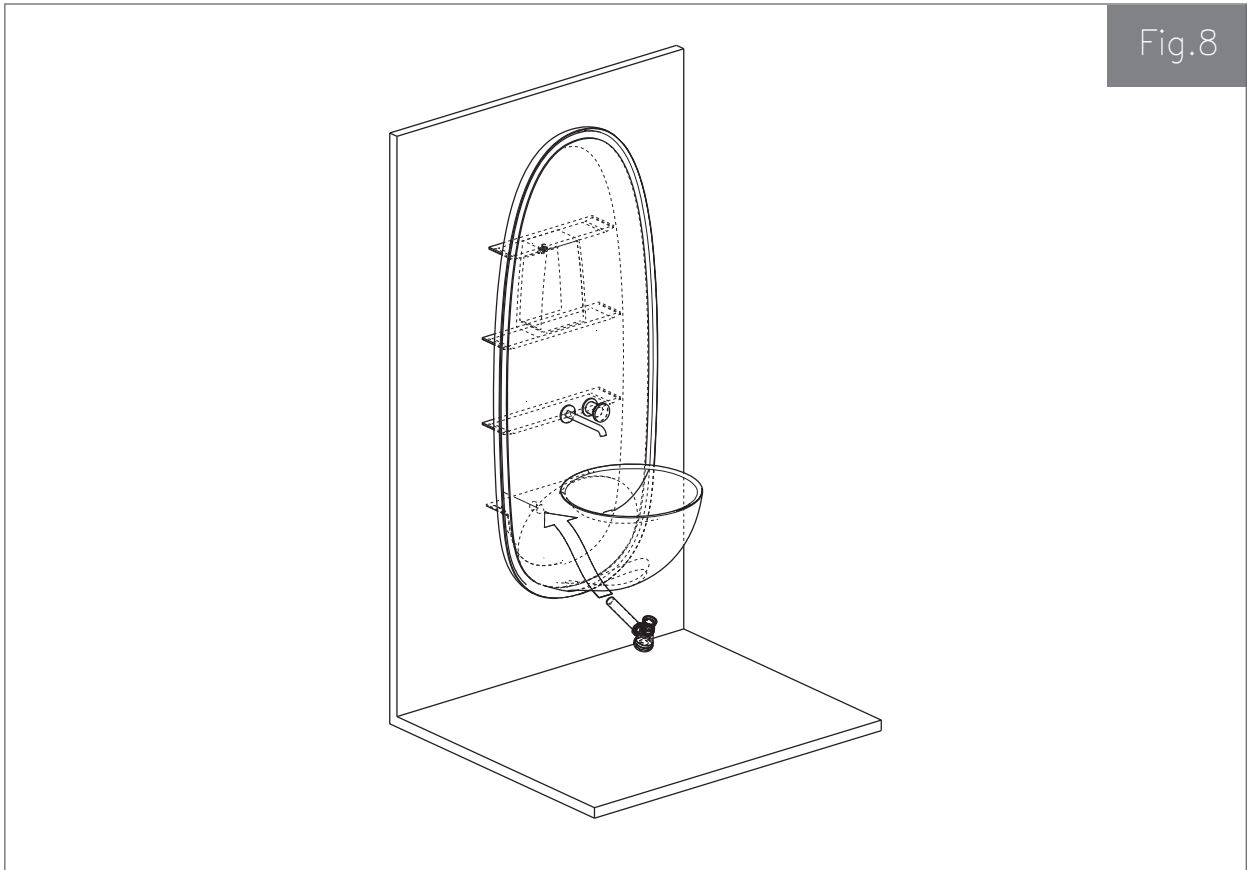

Fig.7

Fig.8



Using the ability to control the inner LED strip with an infinite mirror effect.

Download APP with name “LED Chord” from Mac App Store or from Google Play Market.

Or you can use QR-codes from this instruction.

LED Chord is an APP designed for full color LED controller as a remote controller via Bluetooth.

The program works with activated geolocation.

Main function:

Modifying device's name;

Setting RGB order;

Setting pixels number;

Selecting effects;

Picking static colors;

Modifying speed for effect;

Modifying brightness.



Google Play Market



App Store

When connecting a Portal management controller to your mobile device, select a Portal product controller from the list of possible connections. The factory name of the controller is SP107E. Change the name of controller if needed.

When connecting for the first time, select the GRB color scheme (RGB order) and the WS2811 as strip type from the proposed list.

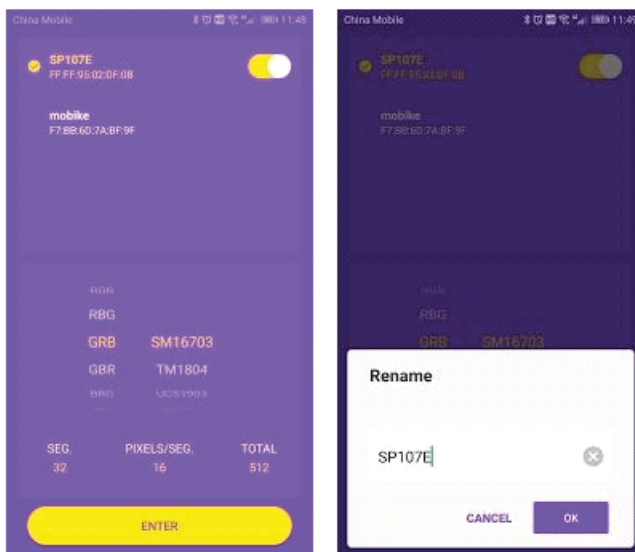

Then check the correctness of the choice of the color palette on the "Color" tab by choosing a color and checking it for compliance with the illuminated color of the ribbon. If necessary, change the RGB order.

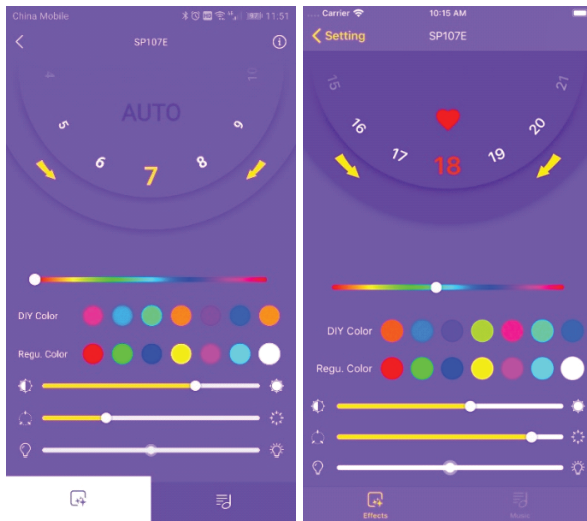

Select the operating mode of the LED strip from the proposed ones saved in the APP. Enjoy!

If the settings fail and the connection to the controller via Bluetooth is lost and is not restored, restart the device by disconnecting the product from the power supply for 45-60 seconds.

It will also be impossible to connect to the product if some of the previous users within the range of the Bluetooth connection already have an active connection with the product. Only one active connection with the product is possible.