

## Touchless faucet Delta C

299-3201-0X



### DESCRIPTION

Automatic touchless faucets and soap dispensers are hygienic and water efficient solution for your bathroom or public restrooms, such as schools, hospitals, airports, restaurants, shopping malls, cinemas. Using sensor beams the automatic faucet or soap dispenser determines when an object is in front of it and automatically turns on and automatically turn off when there is no motion.

#### Benefits of automatic touchless faucets and soap dispensers:

- Help to avoid spreading germs and grime, eliminate bacteria from being spread from person to person
- Reduces water waste by eliminating unnecessary and unattended water flow.
- Gives patrons confidence that their restroom experience will be clean, comfortable, and convenient.

#### Faucet is designed for cold and pre-mixed water.

For pre-mixed water, need to be purchased separately to operate:

- thermostatic mixing valve (product code 952-0004-32) - 1 pc for a maximum of 6 mixers, or
- mechanical mixing valve (product code 952-0004-33) - 1 pc for maximum of 3 mixers

### SPECIFICATION

Type	deck-mounted faucet
Sensor type	Infra-red(IR) sensor activation
Flow rate	5.7 l/min (at request 3.8, 2.0 l/min)
Power supply	AC (110-240V)+DC (6V - 4x1.5V alkaline battery)
Power consumption (faucet)	Active mode≤3.5W, Standby mode≤ 0.8mW
Sensing distance	10-30 cm (adjustable by regular magnet)
Warranty	2 years
Certificate	WRAS and CE approved

### TECHNICAL DATA

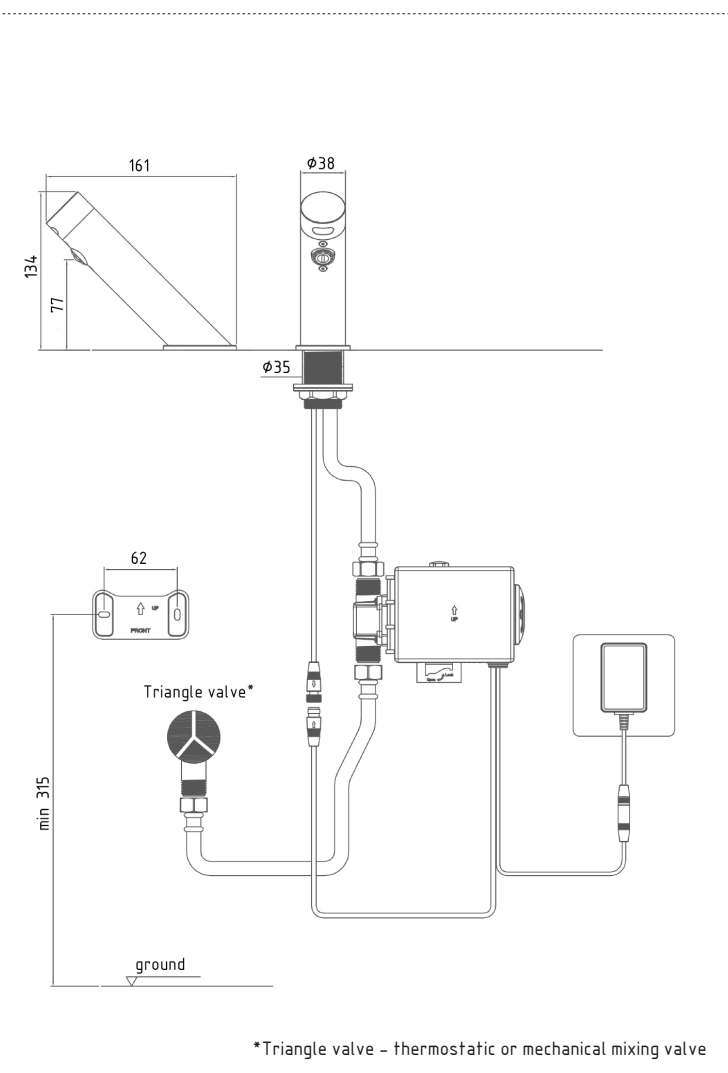
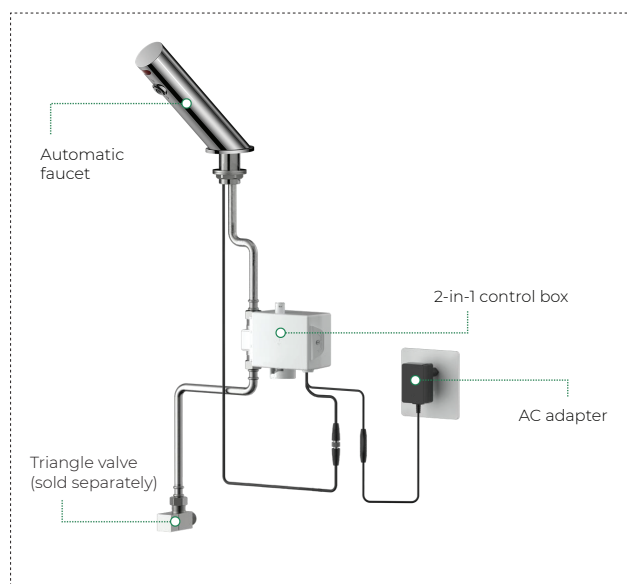

### POSSIBLE SURFACE FINISHING

Chrome plated (CP)	Black mat (BM)
299-3201-01	299-3201-02
299-3201-03	299-3201-04

